

Express Range



Tool free locking device for fast suspension of a variety of services, designed with a keyless release mechanism.

FEATURES / BENEFITS

- The XP1 is ideal for signage, shopfitting, lighting and other lightweight fixtures
- The XP2 is ideal for mechanical and electrical applications
- Up to six times faster to install than traditional methods
- Keyless; no tool required for adjustment
- Ergonomic buttons allow rapid adjustment
- Discreet and aesthetic design
- Supplied as a ready-to-use kit



INSTALLATION & ADJUSTMENT

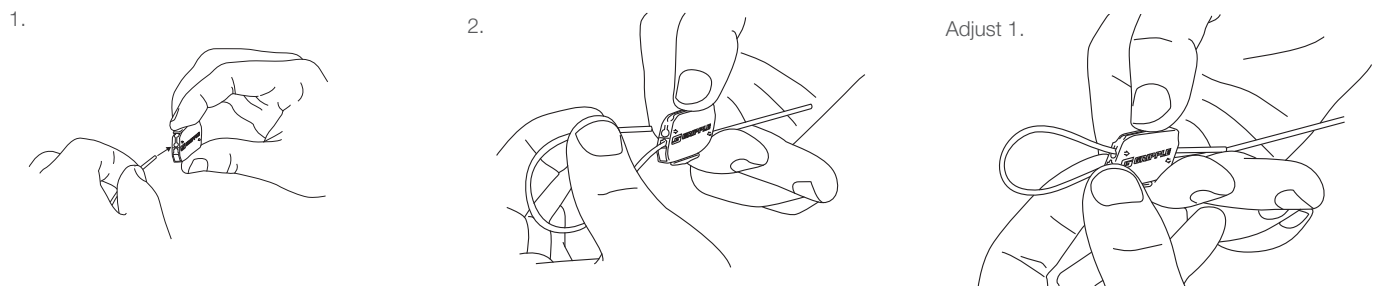

Ensure a minimum 75 mm of tail wire exit the hanger.

SPECIFICATION

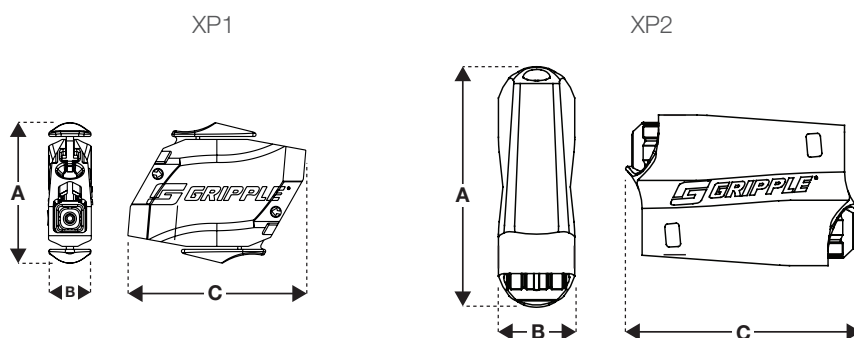

Dimension	No.1 (mm)	No.2 (mm)
A	18.5	21.4
B	5.9	11.6
C	23.5	28.4

AVAILABLE END FIXINGS



For more options on available end fixings please contact us or visit www.gripple.com

SUBMITTAL INFORMATION

Safe Working Load:

No.1 - 0 - 15 kg @ 5:1 safety factor
No.2 - 0 - 45 kg @ 5:1 safety factor

Material:

Housing - Type ZA2 Zinc
Wedge - Sintered steel hardened to min. 56 Rockwell C
Spring - Stainless Steel (Type 302)
End Cap - Polypropylene (MOPLen EP448T)
No. 1 Button - Acetal
No. 2 Button - 30% Glass filled Polypropylene

PI-EXPRESS-ENG

www.gripple.com

Gripple's policy is one of continuous development and innovation. We therefore reserve the right to alter specifications, etc. without notice.



Gripple Ltd | The Old West Gun Works | Savile Street East | Sheffield S4 7UQ
Tel 0800 018 4264 Fax 0114 275 1155 email info@gripple.com