

Roof appliances

FDH

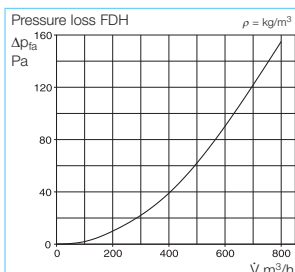
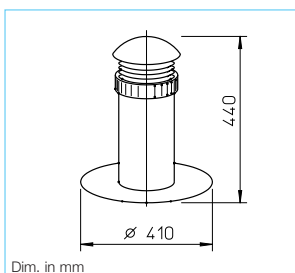

Type FDH Ref. no. 1477

Flat roof outlet

For connection of vent openings, up to 160 mm diameter, via the roof. Made of weather resistant polymer with a wide frame for fixing. Cold and heat resistant up to +200 °C. Cowl can be removed by insertion of a supplied ladder strip or insulation material (on site) to prevent the occurrence of condensation.

Roof outlet DH with roof pantiles FDP, UDP and connector STV

Roof outlet DH with duct



Connector STV



Pitched roof pantile UDP



Flat roof pantile FDP

DH+UDP

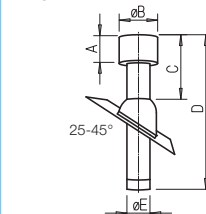

DH+FDP

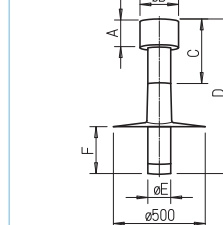

Roof outlet DH

The ideal solution for ventilation system, without static pressure drop. Made of weather resistant polypropylene, removable exhaust outlet with protection against driving rain. Connection with ducting by means of the connector STV (accessory), which obstructs the escape of condensation at the juncture. For the installation of the roof outlet, the following roof pantiles should be used:

- **Roof pantile UDP**, fits almost to every brick model, in black or brick-red. For roofs with inclinations of 25–45°.

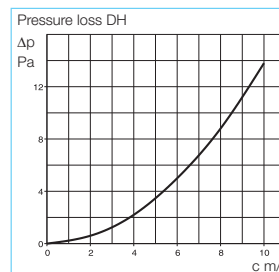

- **Flat roof pantile FDP** made of aluminium for flat roofs.

Model range: Outlet, pantile, connector to be ordered separately.

| DN mm | Roof outlet* | | Roof pantile*, lead | | Roof pantile for flat roof, alu. | | Connector | |
|-------|--------------|----------|---------------------|----------|----------------------------------|----------|-----------|----------|
| Mains | Type | Ref. no. | Type | Ref. no. | Type | Ref. no. | Type | Ref. no. |
| 100 | DH 100 R | 2014 | UDP 100 R | 2020 | FDP 100 | 2024 | STV 100 | 2026 |
| | DH 100 S | 2015 | UDP 100 S | 2021 | | | | |
| 125 | DH 125 R | 2016 | UDP 125 R | 2020 | FDP 125 | 2013 | STV 125 | 2027 |
| | DH 125 S | 2017 | UDP 125 S | 2021 | | | | |
| 160 | DH 160 S | 2019 | UDP 160 S | 2023 | FDP 160 | 2025 | STV 160 | 2028 |

* R = Brick-red, S = Black

Dimensions: Roof outlet DH with roof pantile UDP or FDP

| DN mm | Dimensions in mm | | | | | |
|-------|------------------|-----|-----|------|-----|-----|
| Mains | A | Ø B | C | D | Ø E | F |
| 100 | 120 | 170 | 320 | 785 | 100 | 225 |
| 125 | 140 | 210 | 335 | 825 | 125 | 255 |
| 160 | 180 | 265 | 365 | 1113 | 160 | 345 |